

FOR LEASE

FIRST CLASS INDUSTRIAL/OFFICE BAYS

NAICommercial



280 TAIGANOVA CRESCENT | FORT MCMURRAY, AB

PROPERTY DESCRIPTION

- A unique opportunity to lease well improved north Fort McMurray office/warehouse bays
- Flexible space configurations with contiguous bay space from 3,225 sq.ft.± - 9,675 sq.ft.±
- One grade door per 3,225 sq.ft.± bay
- Convenient proximity to Highway 63 and populated residential neighbourhoods
- Immediate availabilities



FLEXIBLE SPACE
CONFIGURATIONS



PAVED PARKING



WELL POSITIONED
TAIGANOVA LOCATION



GRADE LOADING
DOORS

CONOR CLARKE

Associate
587 635 2480
cclarke@naiedmonton.com

RYAN BROWN

Partner
587 635 2486
rbrown@naiedmonton.com

CHAD GRIFFITHS

Partner
780 436 7414
cgriffiths@naiedmonton.com

DREW JOSLIN

Associate
780 540 9100
djoslin@naiedmonton.com



NAI COMMERCIAL REAL ESTATE INC.
4601 99 STREET NW, EDMONTON AB, T6E 4Y1



780 436 7410



NAIEDMONTON.COM

PROPERTY INFORMATION

LEGAL ADDRESS Plan 1021463, Block 1, Lot 9A

SITE SIZE 3.77 Acres±

AVAILABLE AREA Building 1: 3,225 SF± - 9,675 SF±
Building 3: 3,225 SF± - 6,450 SF±

ZONING BI - Business Industrial

LOADING 12'x16' Grade Doors
(one door per 3,225 sq.ft.± bay)

CEILING HEIGHT 22'

PROPERTY IMPROVEMENTS

- Abundant natural light
- Paved parking
- Flexible demising options
- Fully improved office space
- Telus Fibre Optics onsite
- Professional building management

AVAILABILITY Immediately

LEASE RATE Market

OPERATING COSTS \$6.50/sq.ft./annum (2024)
Includes property taxes, building insurance, common area maintenance and management fees



CONOR CLARKE

Associate
587 635 2480
cclarke@naiedmonton.com

RYAN BROWN

Partner
587 635 2486
rbrown@naiedmonton.com

CHAD GRIFFITHS

Partner
780 436 7414
cgriffiths@naiedmonton.com

DREW JOSLIN

Associate
780 540 9100
djoslin@naiedmonton.com



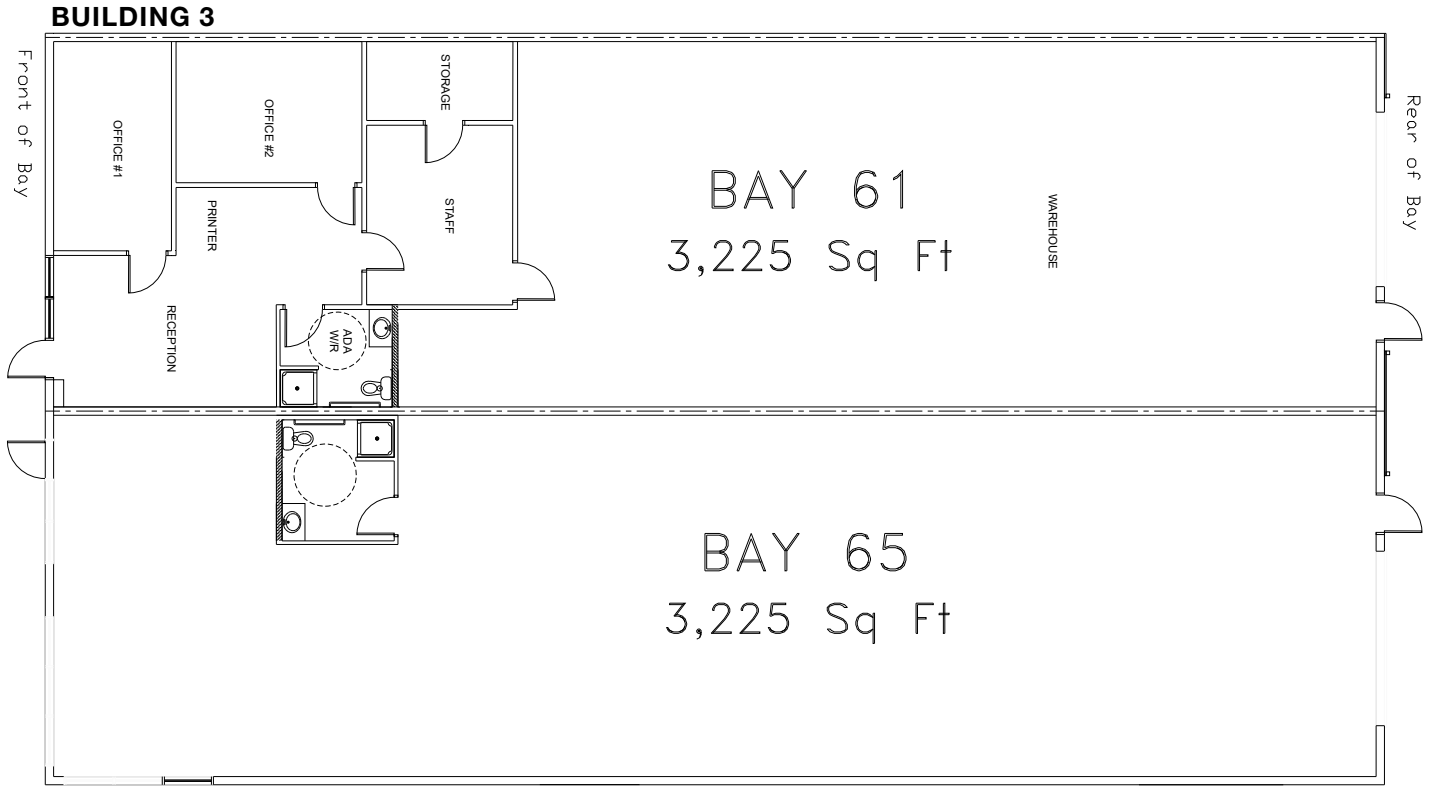

TAIGANOVA CRESCENT

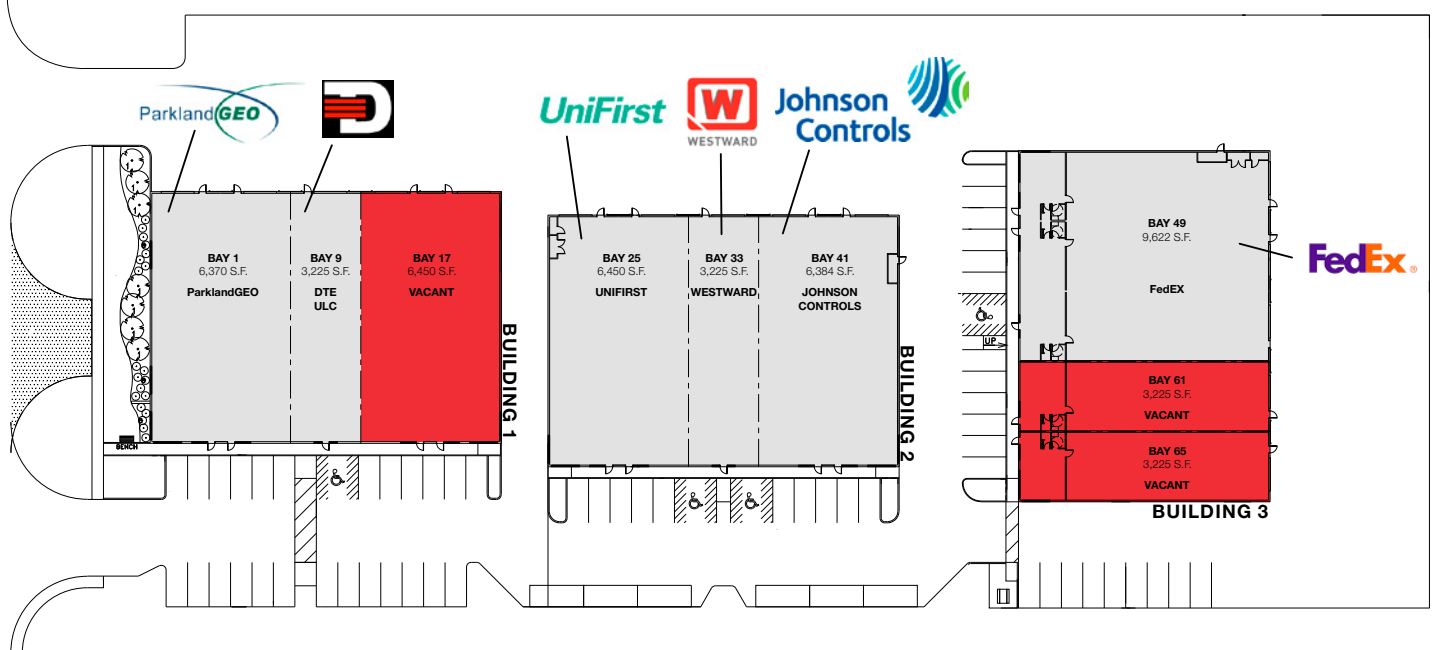

CONOR CLARKE

Associate
587 635 2480
ccclarke@naiedmonton.com

RYAN BROWN

Partner
587 635 2486
rbrown@naiedmonton.com

CHAD GRIFFITHS

Partner
780 436 7414
cgriffiths@naiedmonton.com

DREW JOSLIN

Associate
780 540 9100
djoslin@naiedmonton.com



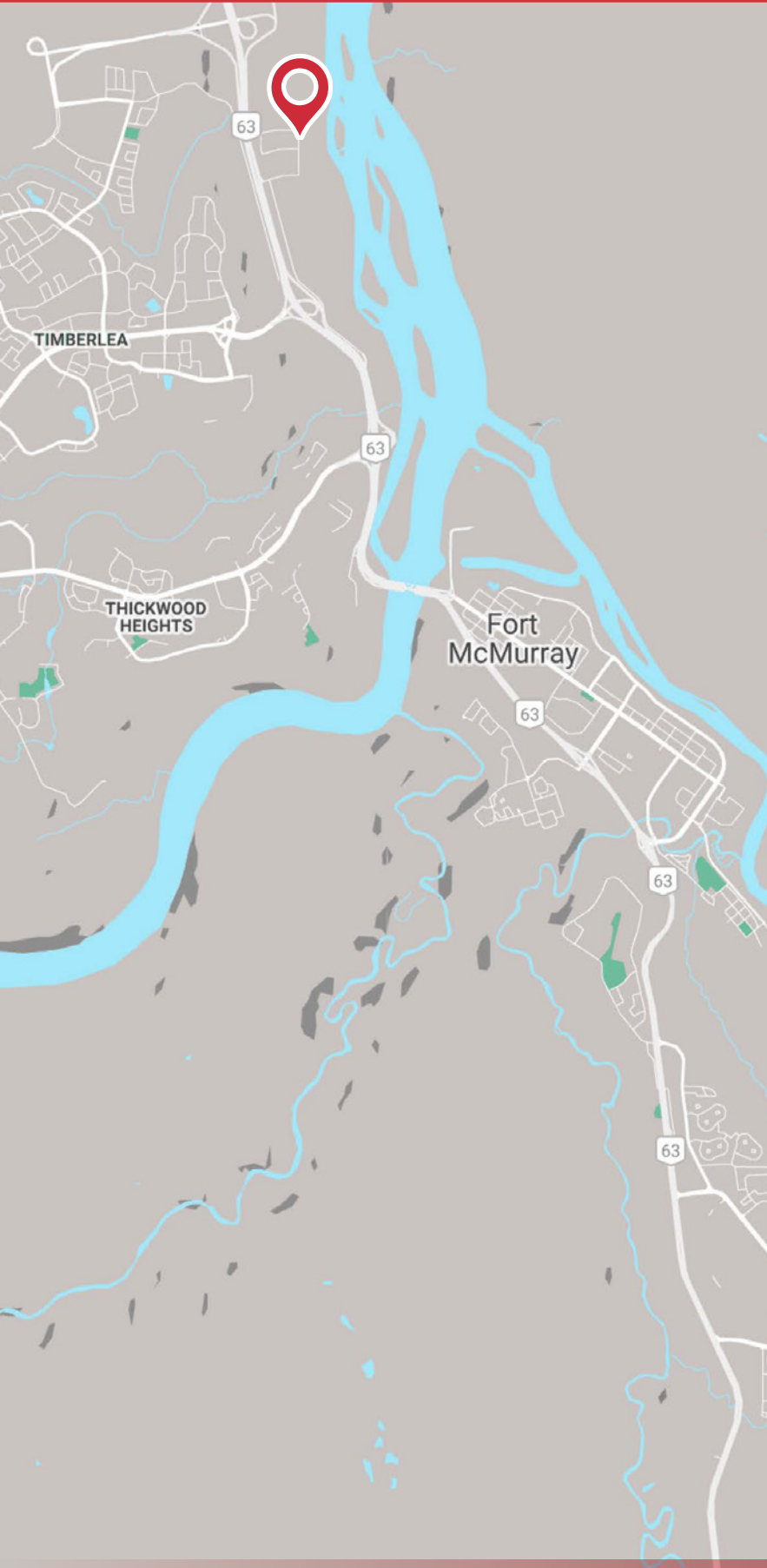

WELL LOCATED WAREHOUSE WITH IMPROVED OFFICE BAYS

Located in the coveted TaigaNova Eco-Industrial Park in north Fort McMurray, 280 Taiganova Crescent is a multi-tenant complex on a 3.77 acre site improved with three office/warehouse buildings. The property has convenient proximity to Highway 63 as well as the neighborhoods containing the majority of Fort McMurray's population.

Building features include grade doors, paved parking, improved office space, high ceilings, and abundant natural light.

OFFERING HIGHLIGHTS INCLUDE

- Contiguous bay space from 3,225 SF± - 9,675 SF±
- One grade door per 3,225 SF± bay
- Immediate availabilities

DEMOGRAPHICS

(Urban Service Area, 2022 est.)

POPULATION: 71,165

Age (2022 Est.)	Income (2022 Est.)		
0-24	32%	Average household income	\$232,593
25-49	46%	Percentage of households that earn more than \$100,000	79%
50-74	21%		
75+	<1%	Percentage of households that earn between \$60,000 to \$100,00	9%
MEDIAN	36		



FOR LEASE

FIRST CLASS INDUSTRIAL/OFFICE BAYS

NAI Commercial

280 TAIGANOVA CRES | FORT MCMURRAY, AB

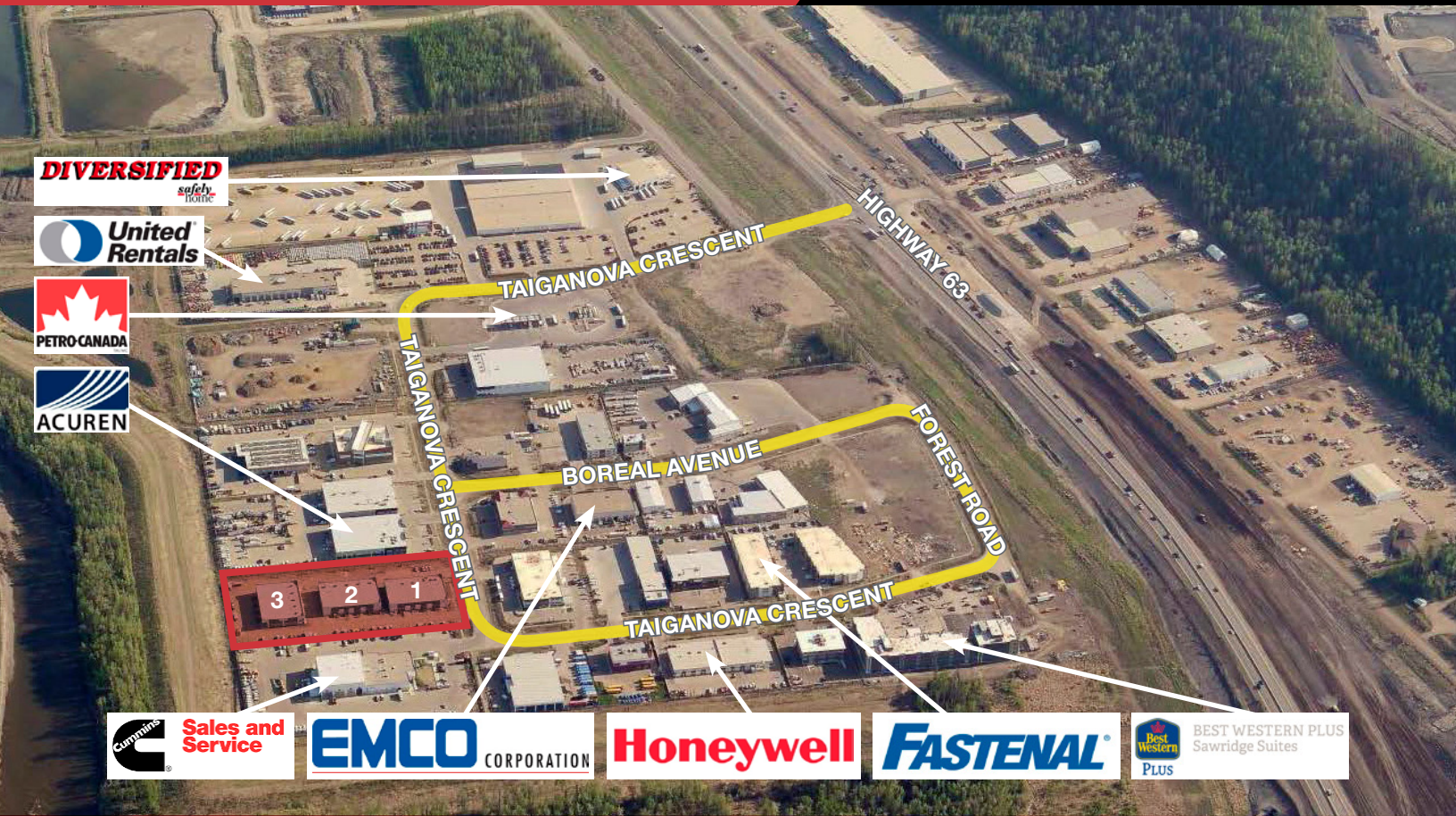

CONOR CLARKE

Associate
587 635 2480
cclarke@naiedmonton.com

RYAN BROWN

Partner
587 635 2486
rbrown@naiedmonton.com

CHAD GRIFFITHS

Partner
780 436 7414
cgriffiths@naiedmonton.com

DREW JOSLIN

Associate
780 540 9100
djoslin@naiedmonton.com

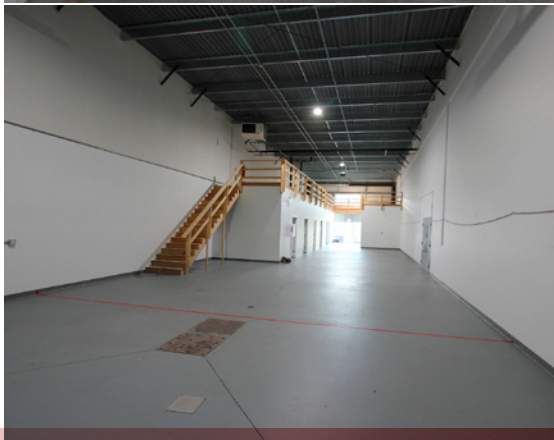

NAI COMMERCIAL REAL ESTATE INC.
4601 99 STREET NW, EDMONTON AB, T6E 4Y1



780 436 7410



NAIEDMONTON.COM

7238-A RB23